

CITY OF NAPOLEON GENERAL PERMIT APPLICATION

THIS APPLICATION IS FOR RESIDENTAL CONSTRUCTION INCLUDING BUILDING, ELECTRICAL,
PLUMBING, MECHANICAL & REMODELING

KH 13-0381
13169

DATE Oct 1 2013 JOB LOCATION 840 monroe st

OWNER Lupe Rivera TELEPHONE # 419 906-0296

OWNER ADDRESS 840 monroe st

CONTRACTOR Tc homeservices LLC CELL PHONE # 419 350-5525

DESCRIPTION OF WORK TO BE PERFORMED Ramp

ESTIMATED COMPLETION DATE Oct 11 ESTIMATED COST 2000.00

Affected Floor Area (AFA): In existing structures, it is the area affected by the improvement, i.e. a new wall dividing a room (the AFA would be only the room and not all the rooms).

DESCRIPTION	FEE	TOTAL COST
BUILDING:		
<i>Decks</i>	\$25.00	\$
<i>Addition & Alterations</i> Square foot in (AFA) x \$0.05 = \$	+ \$25.00 =	\$
Garage and Shed over 200 SF (Detached)	\$25.00	\$
Siding and/or Roofing	\$25.00	\$
Windows/Doors	\$25.00	\$
ELECTRICAL:		
<i>Electrical</i> Circuits in (AFA) x \$3.00/Circuit = \$	+ \$25.00 =	\$
Electrical Service Upgrade	\$25.00	\$
MECHANICAL:		
Water Heater	\$25.00	\$
Furnace and/or AC Replacement	\$25.00	\$
PLUMBING:		
<i>Plumbing</i> Traps in (AFA) x \$3.00/Trap = \$	+ \$25.00 =	\$
TOTAL plus Ohio Board of Building Standards Fee 1% \$		

TOTAL FEE: \$

I FULLY UNDERSTAND THAT NO EXCAVATION, CONSTRUCTION OR STRUCTURAL ALTERATION, ELECTRICAL OR MECHANICAL INSTALLATION OR ALTERATION OF ANY BUILDING STRUCTURE, SIGN, OR PART THEREOF AND NO USE OF THE ABOVE SHALL BE UNDERTAKEN OR PERFORMED UNTIL THE PERMIT APPLIED FOR HEREIN HAS BEEN APPROVED AND ISSUED BY THE CITY OF NAPOLEON BUILDING/ZONING DEPARTMENT.

I hereby certify that I am the Owner of the named property, or that the proposed work is authorized by the Owner of record and that I have been authorized by the Owner to make this application as his/her authorized agent and I agree to conform to all applicable laws of the jurisdiction. In addition, if a permit for Work described in this application is issued, I certify that the code official or the code official's authorized representative shall have the authority to enter areas covered by such permit at any reasonable hour to enforce the provisions of the code(s) applicable to such permit.

I HEREBY ACKNOWLEDGE THAT I HAVE READ AND FULLY UNDERSTAND THE ABOVE LISTED INSTRUCTIONS.

SIGNATURE OF APPLICANT: [Signature] DATE: Oct 1 2013

PRINT NAME:

BATCH # _____ CHECK # 1066 DATE 10-1-13

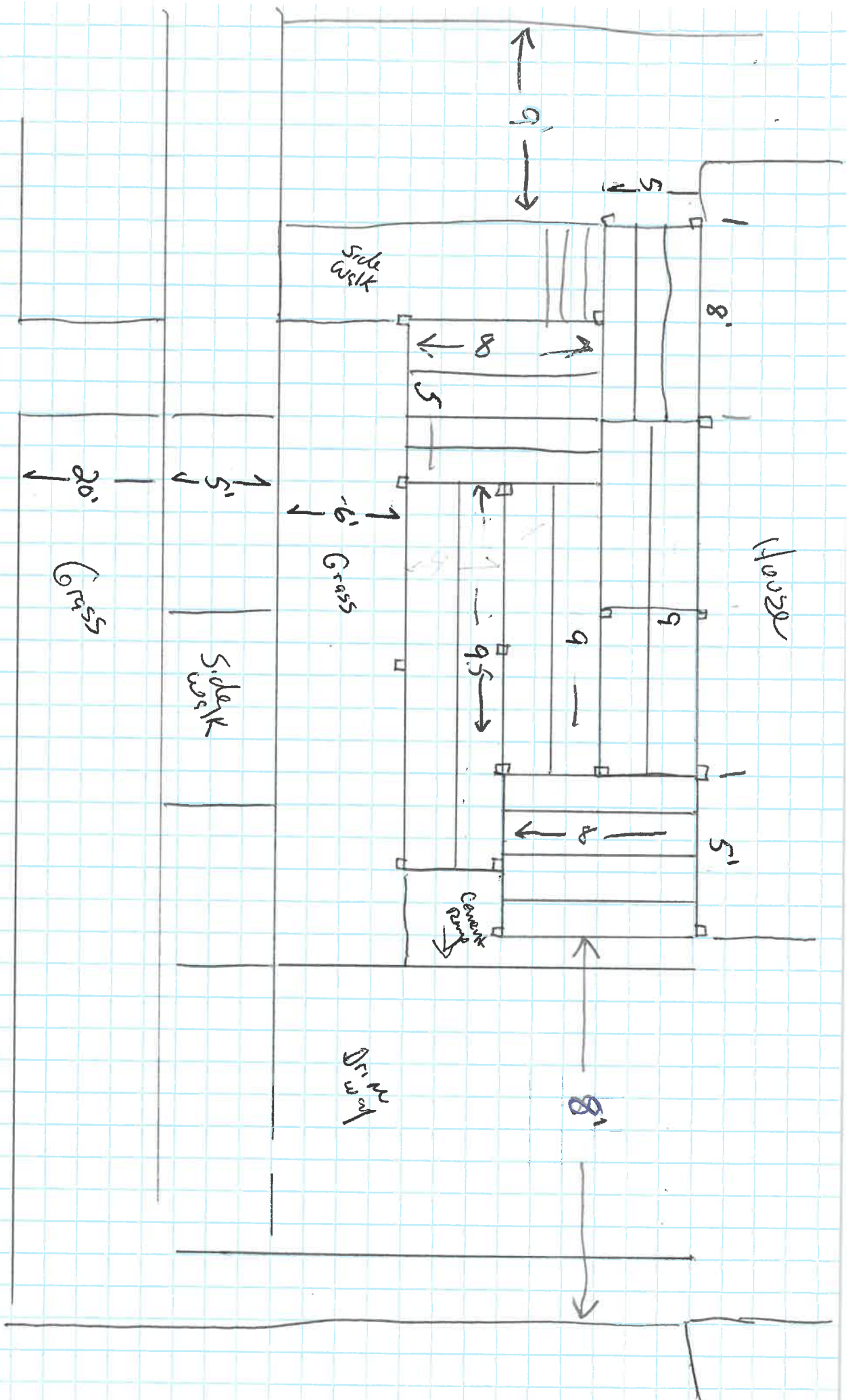

Manroe
Street

Lupe Rivera
540 Manroe St
Napoleon 43545
419 906-0296

Rev 28/12

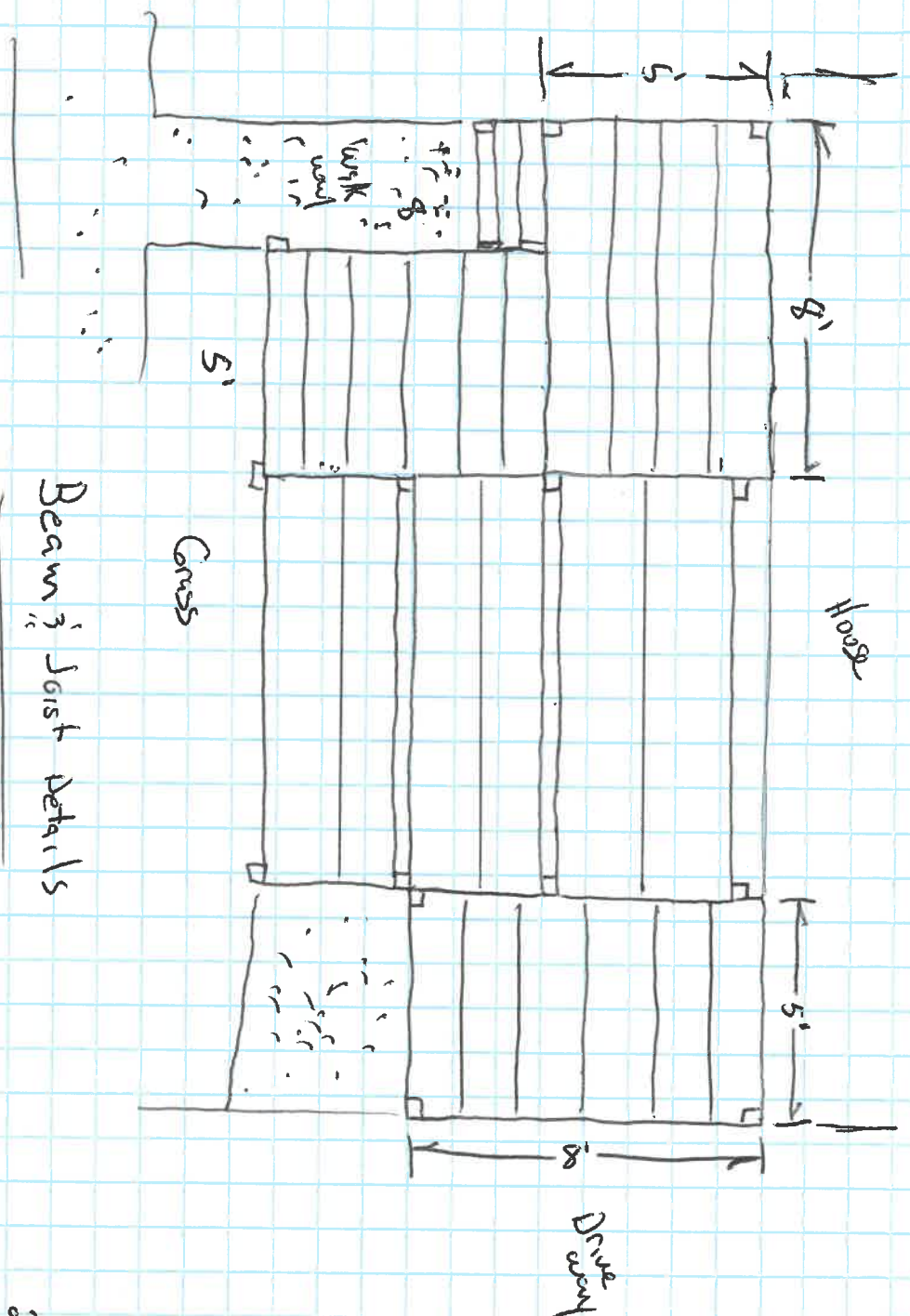

Beam Joist Details

Lupe Rivera
 840 Monroe St
 Napoleon 43545
 (419) 906-0296

28 1/2 Rise

All Pressure treated
 All Fasteners are
 Galvanized Ring Shank

Frame details

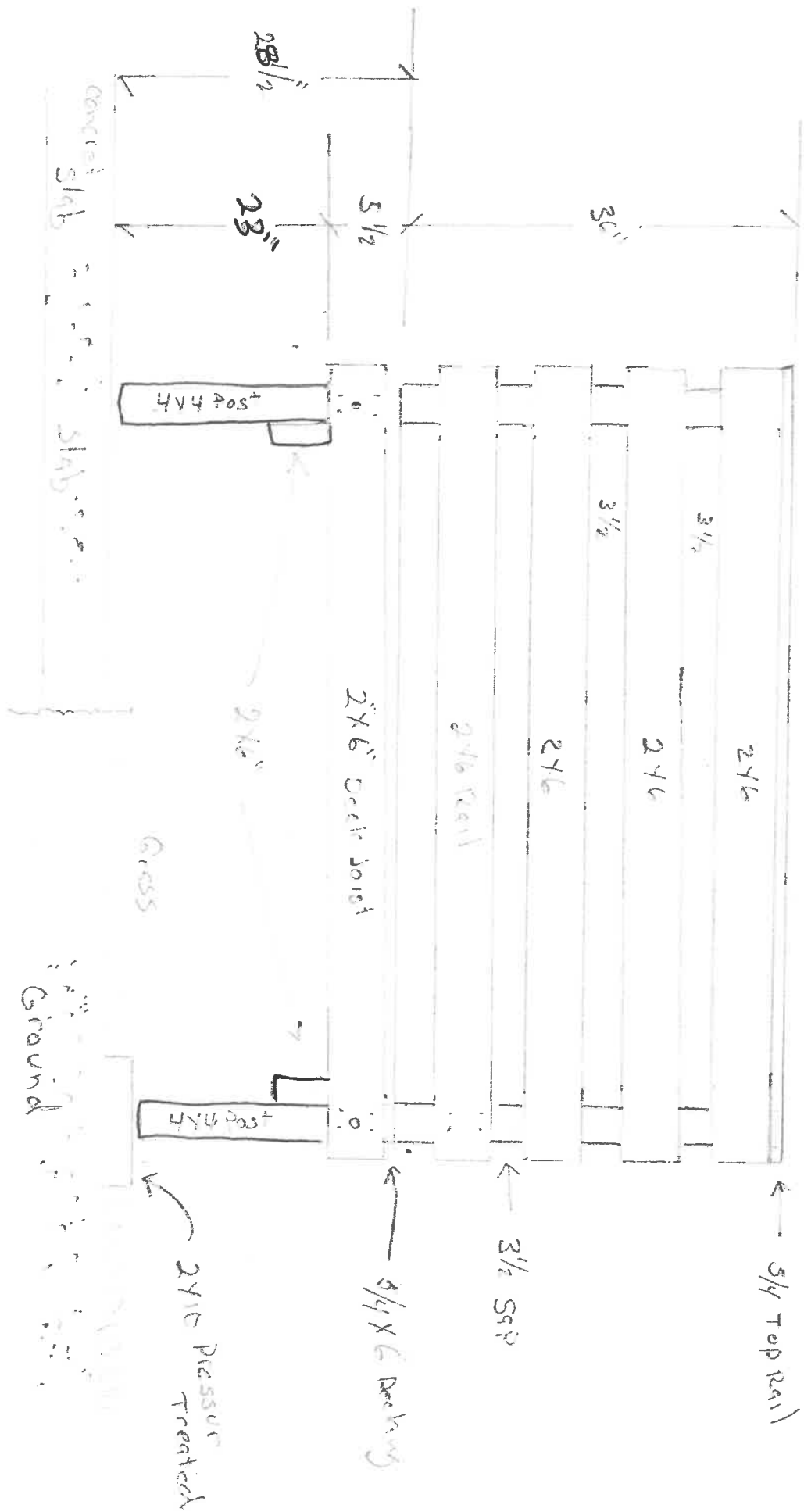

Deck/Ramp Framing Details

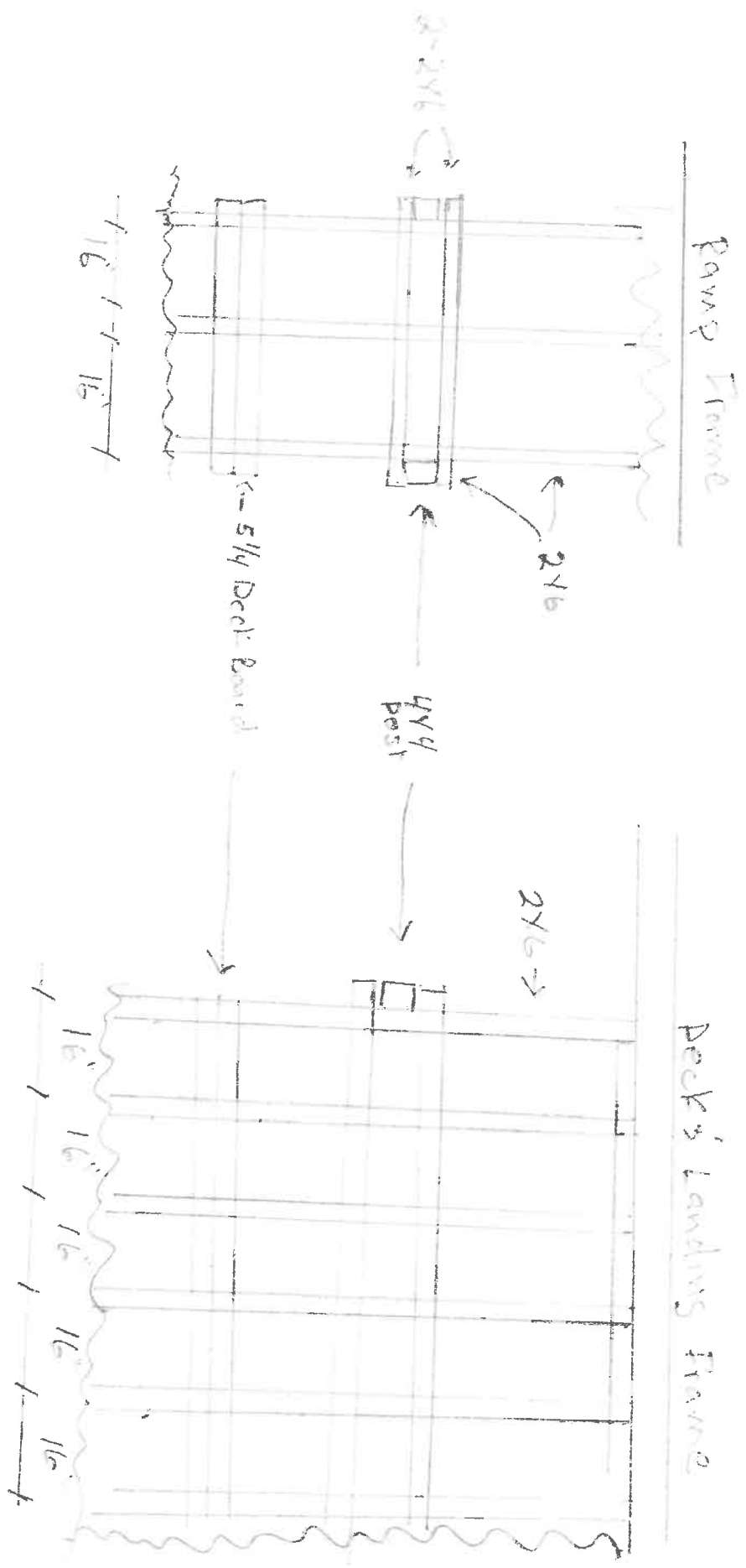

All Lumber is to be Pressure Treated
All Fasteners are to be ACS approved

DECK / RAMP RAILING DETAIL

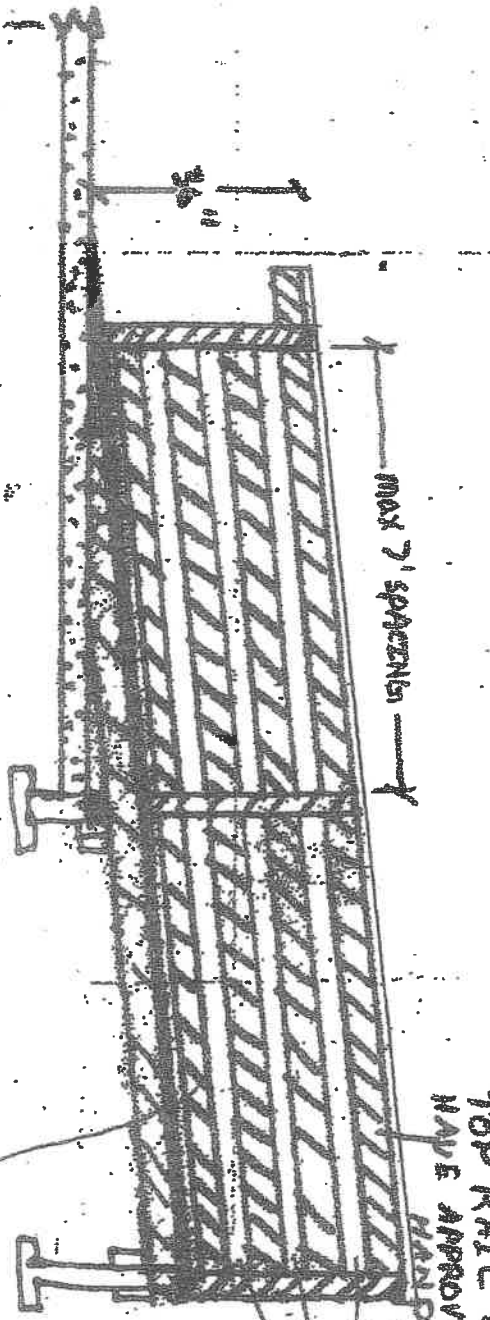

TOP RAIL TO
HAVE APPROVED
HAND GRIP

4" MAX SPACING
BETWEEN
RAILING
BOARDS

TOP RAIL IS 1 1/4" X 2 3/4" TD Hand Rail
HORIZONTAL RAILING
BOARDS ARE 2 X 6 TREATED Lumber